

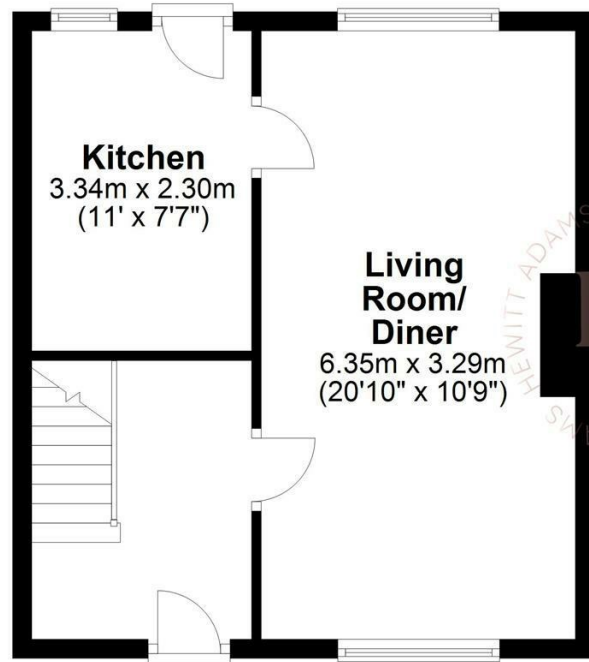

Ground Floor

Approx. 36.1 sq. metres (388.8 sq. feet)



First Floor

Approx. 36.4 sq. metres (392.1 sq. feet)

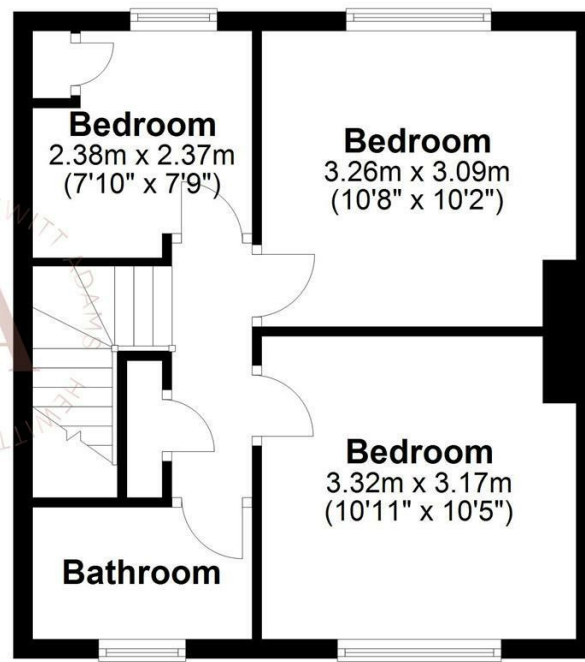

Total area: approx. 72.5 sq. metres (780.9 sq. feet)
For illustration purposes only - not to scale

Fairway North, Wirral, CH62 3LX

£165,000

3 Bedroom 1 Reception 1 Bathroom D

****Three Bedroom Semi - Popular Bromborough Location - A Perfect First Time Buy - No Chain****

Hewitt Adams is delighted to offer to the market this three bedroom semi detached home on Fairway North in Bromborough - a short distance from the centre of the village and the Croft Retail Park where you will find a wide range of local amenities within walking distance.

In the agents opinion this is a perfect property for anyone looking to get onto the property ladder and put their own stamp on their first home.

In brief the accommodation affords: entrance hall, lounge dining room, kitchen. Upstairs there are three good sized bedrooms and the family bathroom.

With off-road driveway parking and a rear garden mainly laid to lawn.

Call Hewitt Adams on 0151 342 8200 to view this no chain property.

Front Entrance

Into:

Hall

Radiator, power points, stairs to first floor, cupboard

Living Room

20'9" x 10'9" (6.35 x 3.29)

Double glazed window, radiator, power points

Kitchen

10'11" x 7'6" (3.34 x 2.30)

Wall and base units, inset sink, integrated oven and gas hob, space and plumbing for washing machine, double glazed window, door to rear

First Floor

Bedroom

10'10" x 10'4" (3.32 x 3.17)

Double glazed window, power points, radiator

Bedroom

10'1" x 10'8" (3.09 x 3.26)

Double glazed window, power points, radiator

Bedroom

7'9" x 7'9" (2.37 x 2.38)

Double glazed window, power points, radiator

Bathroom

4'6" x 7'7" (1.38 x 2.32)

Comprising bath with shower attachment, w.c, wash hand basin, radiator, double glazed window

Externally

Front - driveway parking for one car

Rear - mainly laid to lawn. Side gate access to the front

